



*Appeal from Alzheimer related Disorder Society of India*

*Calcutta Chapter*

*15/3 C Naskarpara Lane, Kolkata 700031*

[www.ardsikolkata.org](http://www.ardsikolkata.org)

*email: ardsikolkata@yahoo.co.in*

*Extension of Dementia services for people of Rural and Semi-Urban area*

ARDSI –Calcutta chapter is a non-profit organization (registration no- S/ 98648) dedicated to care & support for people with dementia since 1999. The activities of the society range from raising awareness to counseling families, training caregivers and providing day and home care.

In India and other developing countries, aging population is increasing and consequently patients with dementia, stroke and Parkinson diseases are also increasing. Dementia disease has tremendous impact on individual, family and also on society. It affects both rich and poor people. Most of the centers for detection of dementia and its counseling are situated in cities. People from rural and semi-urban area face great difficulty reaching the center in the city and receive care & treatment. So, ARDSI Calcutta plans to extend its services in a place close to rural and semi-urban area.

We are happy to inform you that Sri Bholanath Das from Chandernogore has donated a land of about 15,000 sq. feet on the western boundary of the town close to state highway ( Delhi Road). The Governor Sri N K Narayanan of West Bengal has facilitated on behalf of ARDSI- Calcutta.



The Government of West Bengal has also waived off the fees for registration.

We are proud to share that eminent persons such as General Shankar Roy Chowdhury, Justice Chittatosh Mukherjee are our patrons. Mr. Sourav Ganguly, Former-captain of Indian Cricket team, Mr. Soumitra Chatterjee , eminent film personality and Mr. Sirsendu Mukhopadhaya , eminent author are friends of ARDSI Calcutta.

In the donated land, we propose a centre which will have a clinic for diagnosis of dementia due to Alzheimer’s , stroke and Parkinson, a day care centre, an auditorium for regular meeting for academic and awareness purposes, one research centre which will be for epidemiological studies on cognitive dysfunction related to above illness and future scope for genetic studies . This will be G plus 3 building with covered area of about 6577 square feet.

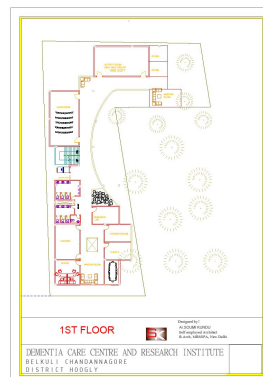
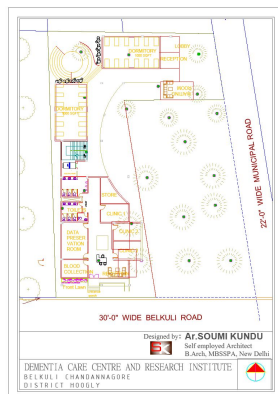

2ND FLOOR

Plan of the proposed building: G + 3

We have received one MP land fund allocation kindly initiated by Dr. Barun Mukherji, of about Rs. Fifty Lakh for construction of clinic cum day care centre. This amount will not be adequate for the whole purpose.

Approximate expenses:

For building; ( @ 1400.00/sq feet for ground floor+ three floors )- 36,831,200.00

For opening Day care centre:

One time capital expenditure- Rs. 50,000.00.00

Recurring (salary honourium)- Rs. 7,80,000.00/ year

(one day care manager, four direct dementia carers, one attendant, one special activity caregiver, one dementia care counselor and care giver welfare officer, one neuropsychologist & one part-time doctor)

Photograph for Building architecture:



Proposed building



Work in progress

A team of dedicated specialist doctors (neurologist and psychiatrist) has agreed to visit this centre weekly to provide service (diagnostic and counseling) without any professional charge.

In order to make our project successful, we want your kind help in contributing financially. This contribution will render extreme help for these ailing patients.

Sincerely

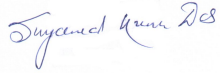

Dr. Shyamal Kumar Das

President

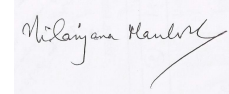

Nilanjana Maulik

Secretary

All donations should be sent:

In favor of ARDSI Calcutta; A/C no- 11000018154 at SBI, Ballygunge Branch, Kolkata, swift code no- SBININBB328.

All donations to ARDSI Calcutta are eligible to income tax relief under 80g APPLICABLE IN India. ARDSI Calcutta also registered under FCR act 2010 to receive donation from abroad.